

## GETTING HERE

### TRAIN STATIONS

**Versailles - Château - Rive Gauche**  
(RER Line C - Paris Austerlitz, Saint-Michel, Champ de Mars-Tour Eiffel)  
**Versailles - Chantiers**  
(departing from Paris Montparnasse)  
**Versailles - Rive Droite**  
(departing from Paris Saint-Lazare)

### Bus RATP 171

Versailles Place d'Armes  
(departing from Pont de Sèvres)

### Parking

**Cars**  
Place d'Armes, Bailly Walk,  
Grand Trianon, Petit Trianon  
and the Queen's Hamlet.

### Buses

Place d'Armes, Petit Pont Walk  
(at the junction between Grand Trianon  
Walk and Petit Trianon Walk).

## ACCESS FOR DISABLED VISITORS

Disabled visitors may be dropped off  
by vehicles near Entrances A and B, in  
the Honour Courtyard of the Palace.

### Full disabled access

State Apartments (in the Palace),  
Grand Trianon

### Partial disabled access

Park, Gardens and Marie-Antoinette's Estate

### Information

+33 (0)1 30 83 78 00  
handicap@chateauversailles.fr

## MAKE YOUR CONTRIBUTION TO HERITAGE PROTECTION

Visitors are requested to throw any  
waste into the waste bins, not to touch  
any vases or statues, not to walk on the  
lawns or to have picnics. Animals must  
be kept on a lead. They are not allowed  
in Marie-Antoinette's Estate or inside  
the gardens and groves. Use of camera  
flashes and mobile phones is prohibited  
inside the Museum. In the interest of  
everyone, proper dress is required.



Use of extendable monopod  
stick poles for smartphones  
is strictly prohibited in  
the rooms of the Museum.



The Museum and Estate are  
under video surveillance.  
Interior Security Code, Articles L251-1 et seq.

For security reasons, conditions of access  
to the Estate may be modified.

## OPENING TIMES

The Palace is open every day, except  
on Mondays and some bank holidays  
or during certain official ceremonies:

- **high season: from 9am to 6.30pm**  
last admissions: 6pm  
- **low season: from 9am to 5.30pm**  
last admissions: 5pm

The gardens and groves are open  
every day:

- **high season: from 8am to 8.30pm**  
last admissions: 8pm  
- **low season: from 8am to 6pm**  
last admissions: 5.30pm

The Park is open every day:

- **high season: from 7am to 8.30pm**  
last admissions: 8pm for pedestrians;  
7pm for vehicles  
- **low season: from 8am to 6pm**  
last admissions: 5.30pm

Opening times are displayed on the  
entrance gates.

The Palaces of Trianon and Marie-  
Antoinette's Estate are open every day,  
except on Mondays and some bank  
holidays or during certain official  
ceremonies:

- **high season:**  
from 12 noon to 6.30pm for the Grand  
Trianon and Petit Trianon  
last admissions: 6pm  
from 12 noon to 7.30pm for the gardens  
the gardens are cleared from 7pm  
and totally closed at 7.30pm  
tickets on sale until 5.50pm  
- **low season: from 12 noon to 5.30pm**  
last admissions: 5pm  
tickets on sale until 4.50pm

The company Montres Breguet SA, Grand Patron  
of the Ministry for Culture and Communication,  
has financed an extensive programme to restore  
the Petit Trianon and French Pavilion.



## BAG DEPOSIT

The following items must be left at the  
bag deposit: walking sticks, umbrellas,  
pointed, sharp or blunt objects, suitcases,  
briefcases, rucksacks, shopping and  
other bags, pushchairs, children's cars,  
push scooters, helmets, camera tripods,  
reproductions and casts.

The visitor rules are available on:  
chateauversailles.fr/reglements



Pickpockets may be operating  
and we therefore ask all visitors  
to remain vigilant.

## ÉTABLISSEMENT PUBLIC DU CHÂTEAU, DU MUSÉE ET DU DOMAINE NATIONAL DE VERSAILLES

RP 834 - 78008 Versailles Cedex

Information and bookings on +33 (0)1 30 83 78 00

[www.chateauversailles.fr](http://www.chateauversailles.fr)

## INTERACTIVE MAP

Prepare your visit and locate all the places and  
services of the Estate.

[bienvenue.chateauversailles.fr](http://bienvenue.chateauversailles.fr)

## VISITOR MOBILE APPLICATIONS

Let our 3 free applications guide you around  
the most iconic parts of the Estate and help you  
explore all the riches of Versailles in photos,  
sound and videos:

- Palace of Versailles
- Gardens of Versailles
- Palaces and Gardens of Trianon

[www.chateauversailles.fr/applications](http://www.chateauversailles.fr/applications)



## GUIDED VISITS

Open the doors and find out more...

Make your way through the history of Versailles  
in the company of those who wrote it:  
Louis XIV, Marie-Antoinette, Louis XVI, Napoleon,  
Louis-Philippe, De Gaulle...

Some ten or so themes for visits with a guide  
to discover the places that are not open to unac-  
companied visits.

### Booking required

+33 (0)1 30 83 78 00  
[www.chateauversailles.fr](http://www.chateauversailles.fr)

### On sale at the Palace

North Ministers' Wing, subject to the number of  
available places.

## ONLINE BOUTIQUE

Versailles delivered straight to your home: sou-  
venirs, books, delicatessen, decoration...

[www.store-chateauversailles.fr](http://www.store-chateauversailles.fr)

## JOIN US ON:



CHÂTEAU DE VERSAILLES

# MAP

# ESTATE OF VERSAILLES

Since 2009, Marly National Estate has been a  
part of the Estate of Versailles. It lies 7km  
north-west of Versailles and is another major  
creation of King Louis XIV, designed by Jules-  
Hardouin-Mansart from 1679 onwards. The  
Estate is open to the public free of charge and  
is currently being restored with the support of  
the local authorities.

More information: [marly.chateauversailles.fr](http://marly.chateauversailles.fr)

## EMERGENCY NUMBERS

**Palace assistance**  
+33 (0)1 30 83 74 18

**Fire Brigade**  
18 or 112

[WWW.CHATEAUVERSAILLES.FR](http://WWW.CHATEAUVERSAILLES.FR)

# DISCOVER THE ESTATE OF VERSAILLES

All unaccompanied visits of the Estate are included in the **Passport** ticket, your key to 350 years of history for 1 or 2 consecutive days. On sale until 3pm (2pm in low season) at the Palace (South Ministers' Wing) and at the Palaces of Trianon. To save time, buy your tickets online on [www.chateauversailles.fr](http://www.chateauversailles.fr)

## PALACE



Admission with the Passport or Palace ticket  
"Palace" audioguide included

**UNACCOMPANIED VISITOR CIRCUITS\*:**  
Access via Entrance A

- **GALLERY OF THE HISTORY OF THE PALACE**  
11 rooms devoted to the history of the creation of the Palace of Versailles (works, models, videos, etc.).

- **STATE APARTMENTS (HALL OF MIRRORS, THE KING'S CHAMBER)**  
The ceremonial apartments of the Kings of France, at the heart of the Palace and the life of the Court.

- **MESDAMES' APARTMENTS**  
The apartments of the daughters of Louis XV, this lavishly furnished double apartment bears testimony to the refinement of Versailles in the 18<sup>th</sup> century.

- **LOUIS XIV ROOMS**  
A broad overview of the 17<sup>th</sup> century presenting the King, his family, the Court and the major events of the time. **Open intermittently.**

- **GALLERY OF BATTLES**  
Left over from the Museum of the History of France created by Louis-Philippe in the 19<sup>th</sup> century, this gallery celebrates all the French dynasties through some thirty monumental paintings. **Open intermittently.**

**EXHIBITIONS HELD IN THE PALACE**

## GARDENS AND GROVES



Access free of charge, except on Musical Fountains Show and Musical Gardens days

Laid out by André Le Nôtre, the gardens of Versailles with their flowerbeds, groves, statues and fountains, are the perfect example of the French-style formal garden.

## MUSICAL FOUNTAINS SHOW AND MUSICAL GARDENS

Admission with the Passport.  
Admission with Musical Fountains Show and Musical Gardens tickets (on sale at entrance to the gardens).

## PALACES OF TRIANON AND MARIE-ANTOINETTE'S ESTATE



Admission with the Passport or Palaces of Trianon ticket

**UNACCOMPANIED VISITOR CIRCUITS\*:**  
Access all year round via the Grand Trianon or Petit Trianon. Access via the gate of the Farm in high season

- **GRAND TRIANON**  
A pink marble palace built by Louis XIV in 1670 as a place to meet his lover Madame de Montespan, the Grand Trianon remained very much a private palace from Napoleon through to Charles de Gaulle.

- **PETIT TRIANON**  
Set in English-style landscaped gardens, the Petit Trianon holds tender memories of Queen Marie-Antoinette who made it her refuge from the pomp and circumstance of the Court.

- **QUEEN'S HAMLET**  
With its rustic workshops set around the Lake, Marie-Antoinette's village was inspired by Enlightenment philosophy and recreates the charms of country life on the eve of the Revolution.

- **GRAND TRIANON GARDENS, FRENCH GARDEN, ENGLISH GARDEN**

**EXHIBITIONS HELD IN THE GRAND TRIANON**

# PALACE OF VERSAILLES

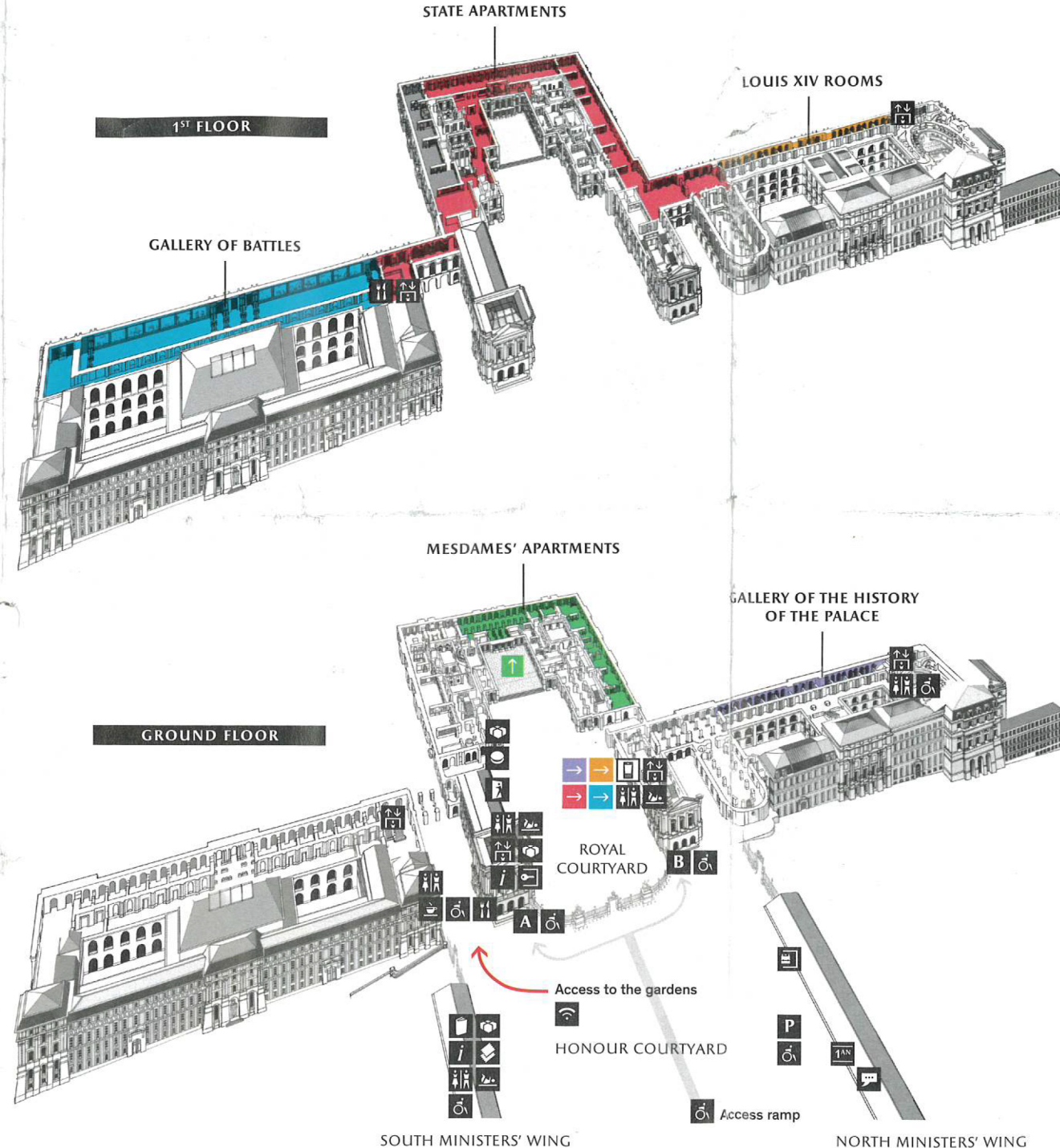

## MAJOR RENOVATION WORKS AT VERSAILLES

In order to enhance conditions for visitors and protect our heritage, a major programme of work is underway to restore the Palace and gardens.

**The Queen's State Apartment is closed for work.**

We apologise to visitors for any inconvenience this might cause.

- A** Access for individual visitors with tickets
- B** Access for groups for unaccompanied visits with prior booking
- Facilities for visitors with reduced mobility
- Lift
- Information
- Tickets for individual visitors
- P** 2 parking spaces reserved for unaccompanied visitors with reduced mobility
- Tickets and departures for guided tours
- Subscription "A year in Versailles" card
- Free WiFi
- Free toilets
- Baby-changing tables
- Bag deposit
- Bag deposit for schools
- Audioguides
- Librairie des Princes Bookshop
- Souvenirs
- Grand Café d'Orléans +33 (0)1 39 50 29 79
- Macaroons
- Restaurants  
**ore**  
DUCASSE  
AU CHÂTEAU DE VERSAILLES  
Opening Summer 2016  
Angéline  
+33 (0)1 39 20 08 32
- Exit

\* Except exceptional closing days.

This group of monuments is on the UNESCO World Heritage List. Inclusion in this list recognises the universal and exceptional value of a cultural or natural asset in order to protect it for the benefit of Humanity.

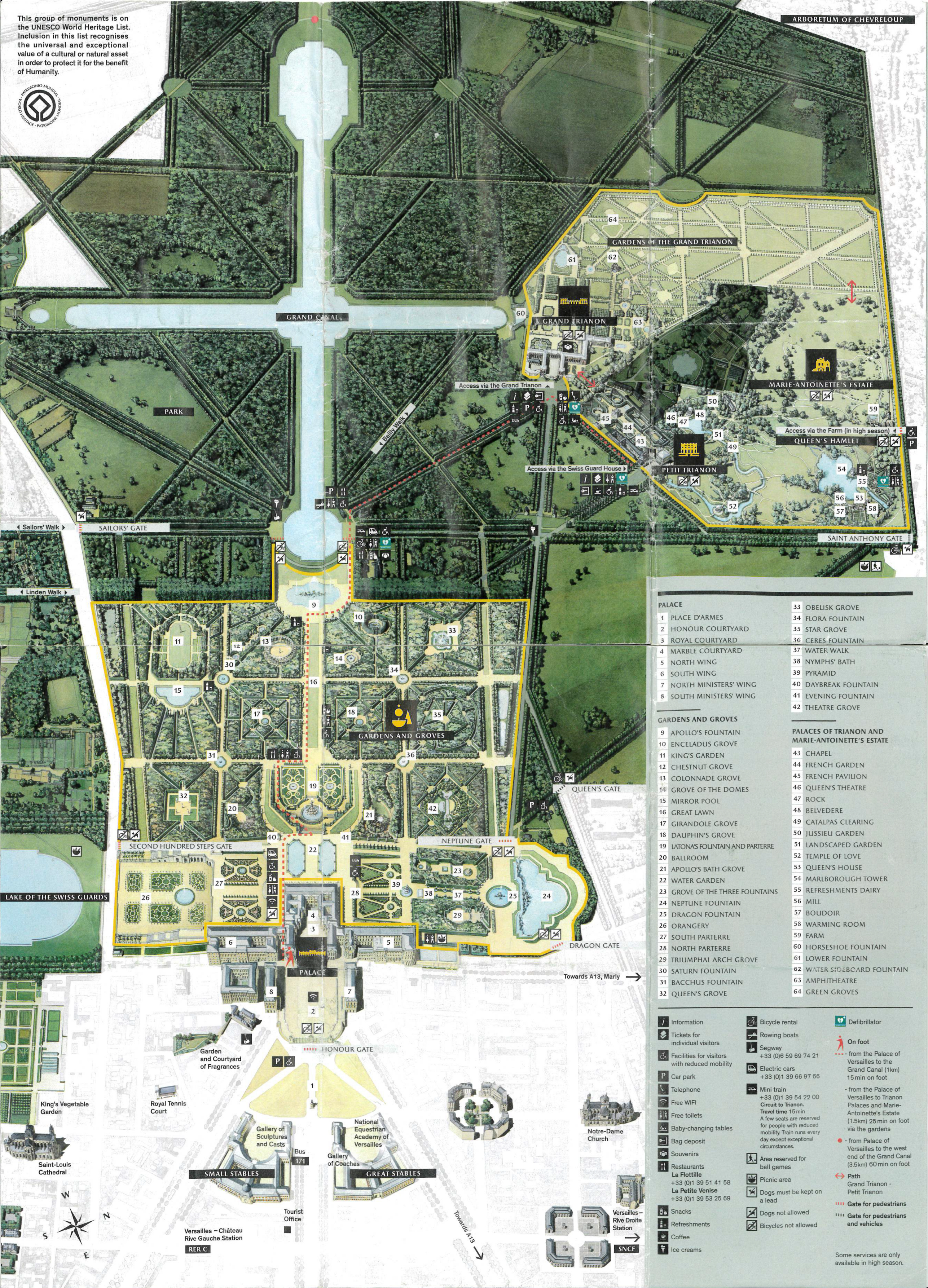

- |   |                      |
|---|----------------------|
| <b>PALACE</b>   |                      |
| 1 PLACE D'ARMES   | 33 OBELISK GROVE     |
| 2 HONOUR COURTYARD                                      | 34 FLORA FOUNTAIN    |
| 3 ROYAL COURTYARD                                       | 35 STAR GROVE        |
| 4 MARBLE COURTYARD                                      | 36 CERES FOUNTAIN    |
| 5 NORTH WING  | 37 WATER WALK        |
| 6 SOUTH WING  | 38 NYMPHS' BATH      |
| 7 NORTH MINISTERS' WING                                 | 39 PYRAMID           |
| 8 SOUTH MINISTERS' WING                                 | 40 DAYBREAK FOUNTAIN |
|   | 41 EVENING FOUNTAIN  |
|   | 42 THEATRE GROVE     |
| <b>GARDENS AND GROVES</b>                               |                      |
| 9 APOLLO'S FOUNTAIN                                     |                      |
| 10 ENCELADUS GROVE                                      |                      |
| 11 KING'S GARDEN  |                      |
| 12 CHESTNUT GROVE                                       |                      |
| 13 COLONNADE GROVE                                      |                      |
| 14 GROVE OF THE DOMES                                   |                      |
| 15 MIRROR POOL  |                      |
| 16 GREAT LAWN   |                      |
| 17 GIRANDOLE GROVE                                      |                      |
| 18 DAUPHIN'S GROVE                                      |                      |
| 19 LATONA'S FOUNTAIN AND PARTERRE                       |                      |
| 20 BALLROOM   |                      |
| 21 APOLLO'S BATH GROVE                                  |                      |
| 22 WATER GARDEN   |                      |
| 23 GROVE OF THE THREE FOUNTAINS                         |                      |
| 24 NEPTUNE FOUNTAIN                                     |                      |
| 25 DRAGON FOUNTAIN                                      |                      |
| 26 ORANGERY   |                      |
| 27 SOUTH PARTERRE                                       |                      |
| 28 NORTH PARTERRE                                       |                      |
| 29 TRIUMPHAL ARCH GROVE                                 |                      |
| 30 SATURN FOUNTAIN                                      |                      |
| 31 BACCHUS FOUNTAIN                                     |                      |
| 32 QUEEN'S GROVE  |                      |
| <b>PALACES OF TRIANON AND MARIE-ANTOINETTE'S ESTATE</b> |                      |
| 43 CHAPEL   |                      |
| 44 FRENCH GARDEN  |                      |
| 45 FRENCH PAVILION                                      |                      |
| 46 QUEEN'S THEATRE                                      |                      |
| 47 ROCK   |                      |
| 48 BELVEDERE  |                      |
| 49 CATALPAS CLEARING                                    |                      |
| 50 JUSSIÉU GARDEN                                       |                      |
| 51 LANDSCAPED GARDEN                                    |                      |
| 52 TEMPLE OF LOVE                                       |                      |
| 53 QUEEN'S HOUSE  |                      |
| 54 MARLBOROUGH TOWER                                    |                      |
| 55 REFRESHMENTS DAIRY                                   |                      |
| 56 MILL   |                      |
| 57 BOUDOIR  |                      |
| 58 WARMING ROOM   |                      |
| 59 FARM   |                      |
| 60 HORSESHOE FOUNTAIN                                   |                      |
| 61 LOWER FOUNTAIN                                       |                      |
| 62 WATER SHOEBARD FOUNTAIN                              |                      |
| 63 AMPHITHEATRE   |                      |
| 64 GREEN GROVES   |                      |

- |  |   |   |
|--|---|---|
| Information  | Bicycle rental  | Defibrillator   |
| Tickets for individual visitors  | Rowing boats  | On foot   |
| Facilities for visitors with reduced mobility  | Segway<br>+33 (0)6 59 69 74 21  | - from the Palace of Versailles to the Grand Canal (1km) 15 min on foot   |
| Car park   | Electric cars<br>+33 (0)1 39 66 97 66   | - from the Palace of Versailles to Trianon Palaces and Marie-Antoinette's Estate (1.5km) 25 min on foot via the gardens |
| Telephone  | Mini train<br>+33 (0)1 39 54 22 00<br>Travel time 15 min<br>A few seats are reserved for people with reduced mobility. Train runs every day except exceptional circumstances. | - from Palace of Versailles to the west end of the Grand Canal (3.5km) 60 min on foot                                   |
| Free WIFI  | Baby-changing tables  | Path Grand Trianon - Petit Trianon  |
| Free toilets   | Souvenirs   | Gate for pedestrians and vehicles   |
| Baby-changing tables   | Restaurants La Flottille<br>+33 (0)1 39 51 41 58<br>La Petite Venise<br>+33 (0)1 39 53 25 69  |   |
| Bag deposit  | Snacks  |   |
| Souvenirs  | Refreshments  |   |
| Restaurants La Flottille<br>+33 (0)1 39 51 41 58<br>La Petite Venise<br>+33 (0)1 39 53 25 69 | Coffee  |   |
| Ice creams   | Bicycles not allowed  |   |

Some services are only available in high season.